

Horizon 8010 LIVING QUARTERS

The Horizon 8010 Living Quarter boasts the industry leading characteristics that are expected in a Sundowner Trailer including all aluminum construction, full bathroom and an array of standard features for the comfort and safety of owners and horses. The 8010 comes in 2 to 8 horse models. The Living Quarter features an air conditioner, furnace, microwave, 2 burner cook top, AM/FM radio CD/DVD player, sofa, walk-in closet and a separate toilet and shower.

INTERIOR STANDARD FEATURES

- 15,000 BTU a/c with heat strip
- Wallboard walls and ceiling
- Wooden window frames
- Raised panel cabinet doors
- Overhead cabinets above sofa and kitchen area
- 8 Cu. ft 12v electric refrigerator
- 2 Burner cook top with cover, range hood and exhaust fan
- Microwave
- Formica counter tops
- Single bowl kitchen sink
- TV Antenna
- AM/FM radio, CD/DVD player with interior and exterior speakers
- Jack knife sofa
- Day/night shades
- Color coordinated valances
- Choice of vinyl flooring with carpeted bedroom
- Mattress
- Quilt
- TV Stand
- Wardrobe and linen closet
- Recessed LED lights
- Towel rack, ring and paper holder
- Toilet
- Shower
- Metal grab handle
- Power roof vent in bathroom
- Fresh water tank, size varies
- 12 volt demand water pump
- City water hook up
- 31 gallon black water tank
- 31 gallon gray water tank
- Sewer dump hose and storage compartment
- 2, 20 lb. propane tanks with automatic change over valve
- 6 gallon electric/gas water heater, automatic recovery
- Water drains and water heater bypass for easy winterizing
- Furnace
- Heavy duty 65 amp 12 volt power converter, battery charger
- 12 volt charge line to truck
- 12 volt battery disconnect switch
- 30 amp marine style 30' power cord lifeline with 12 amp adapter
- 120 volt kitchen and bathroom receptacles, GFI protected
- All wiring checked and rechecked at 1,080 volts
- LP gas leak detector
- Emergency exit windows
- Smoke alarm and fire extinguisher

- Tempered safety glass with positive locks and screens
- Consumer protection seals
- Code approved in all 50 states

TRAILER STANDARD EQUIPMENT

- 2 5/16" Gooseneck hitch, adjustable
- Slant load
- 2 to 8 Horse
- 8' Wide
- 7'6" Tall
- 39" Wide stalls
- All aluminum construction
- All aluminum floors
- Choice of exterior skin color
- Extruded aluminum lower sides
- 2 Rubber torsion axles
- 4 Wheel electric brakes with safety breakaway
- Rear rubber bumper
- 4 Tail lights
- Spare tire and aluminum wheel
- Switch to operate marker lights when parked
- Drop leg jack
- Double battery box with 2 batteries
- Air flow dividers with pads
- Floor mats in horse area
- Drop down feed door with sliding window per stall behind first
- Center access door from horse area to living area
- First stall access door with window, cam latch and black latch
- Feed manger with access door on all stalls behind the first stall
- 2 Air gaps with Plexiglas on rump side
- Tack room door with window and fold down step
- 22 x 36 Escape windows in gooseneck
- Porch light
- Telescoping rear divider
- 48" SunCoat™ entire horse area
- Horse vent per stall
- Double rear doors with Plexiglas on load side door, solid rear tack door
- Dome light in horse area first stall rump side
- 2 Inside/1 outside tie ring per stall
- Collapsible rear tack with saddle rack, tack hooks and dome light

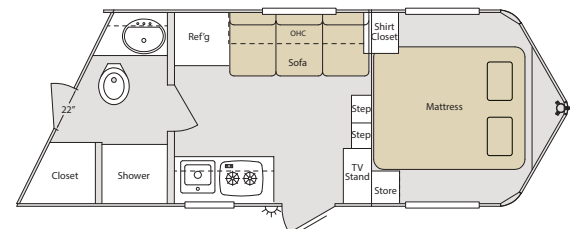
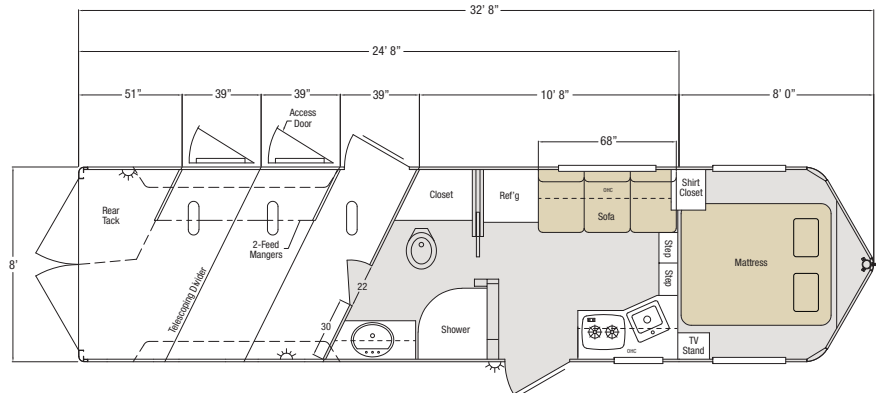

POPULAR OPTIONS

- Additional dome lights
- Load lights
- Aluminum face guard
- Rear ramp
- Awning
- Hay rack
- Rump side window package/model (window per stall on rump side and a window in the load side rear door)

- Round shower
- Pocket door to bathroom
- Skylight dome in shower
- Stainless nose wrap
- Weld on hinge package

All dimensions are approximate. Photos may show options. Due to constant product improvements, specifications, component parts, standard and optional equipment are subject to change without notice or obligation. Refer to standard and special features for specifics. See your dealer for warranty details. 2021 © Sundowner Trailers, Inc (8.16.21)

SUNDOWNER TRAILERS, INC.

9805 OK Highway 48 South • Coleman, Oklahoma 73432-8523

800-438-4294 • sundownertrailer.com